

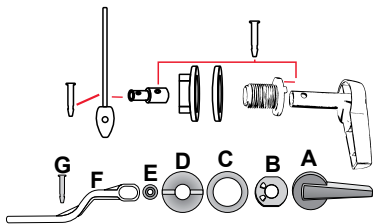

FITTING INSTRUCTIONS

SA9187
C_03/2022

Front flush handle installation



- A : FLUSH HANDLE
- B : FLUSH HANDLE BUSH
- C : CONICAL WASHER
- D : FLUSH HANDLE SECURING NUT
- E : EXTENSION PIECE
- F : FLUSH ARM
- G : FLUSH ARM

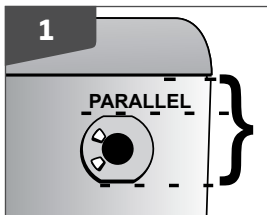
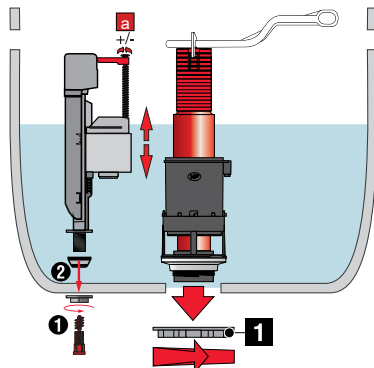

Place the bush (B) through the ½" hole in the front of the cistern wall, ensuring flat part parallel with cistern rim.

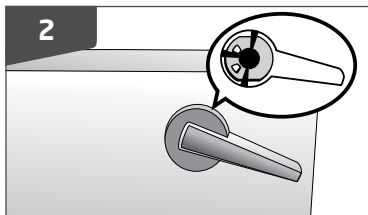

Place handle (A) through bush (B), ensuring middle rib is between the 2 raised pins. Fit ½" conical washer (C) on the bush inside the cistern, with conical side facing cistern inner wall. Once flush handle securing nut (D) has been tightened, flush handle should assume offset position as in illustration 2.

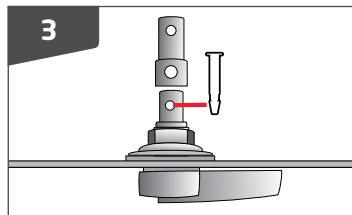

Secure extension piece (E) to flush handle (A) with pin (G).

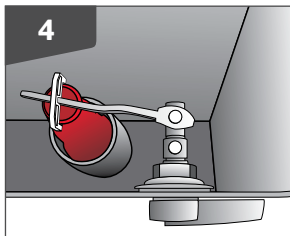

Insert the flush arm between the overflow and the clip. Attach flush arm to flush handle with pin (G).

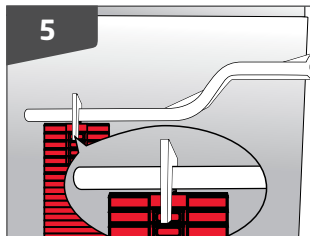

Ensure that the clip is attached to the 1st recess of the overflow.

PLEASE NOTE:

- Following the written and visual instructions in step 1 & 2 are of utmost importance if the mechanical stop is to be installed properly, this will prevent the mechanism from defaulting if excessive force is applied to the handle when flushed.
- **GUARANTEE WILL BE VOID IF: Putty is used - NO PUTTY !! Silicone is used - NO SILICONE !! Water pressure > 16 BAR !!**
- **IMPORTANT INFORMATION: We recommend that this product should be used under BALANCED WATER PRESSURE !**



WIRQUIN Manufacturing, 2 Brickfields Road, Alexander Park, Kariega - 6229
T: +27 42 243 6000 | Email: enquires@wirquin.co.za

www.wirquin.co.za

wirquin